

# SHT26-C024UP

## Counterbalance Monitor Arm

Fits most 17"-32" Flat & Curved Monitors

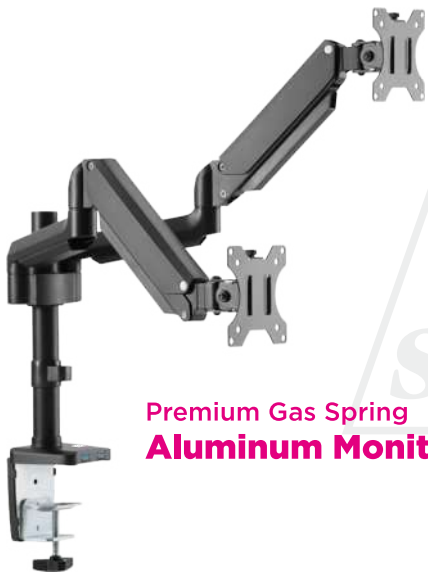

Premium Gas Spring  
Aluminum Monitor Arm

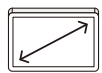
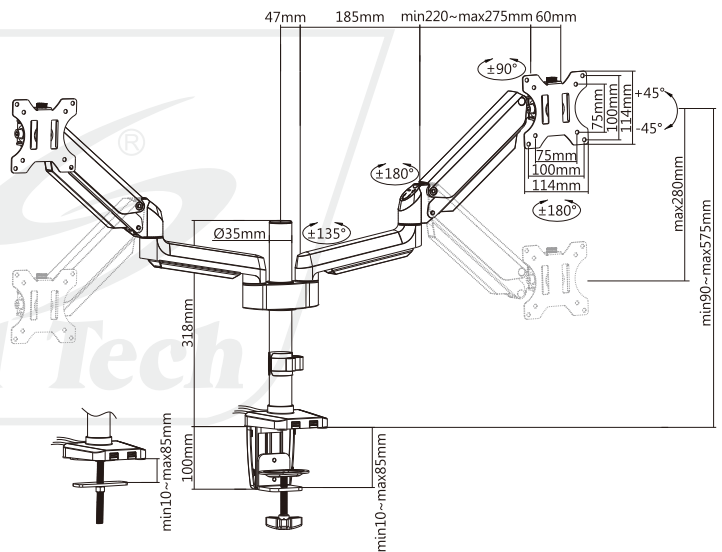

Screen Size  
17"-32"

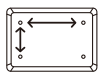

VESA Compatible  
75x75 100x100



Weight Capacity  
1.5-8kg (x2)



Tilt Range  
+45° - -45°

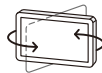

Swivel Range  
+90° - -90°



Screen Rotation  
+180° - -180°

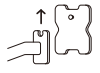

Detachable  
VESA Plate

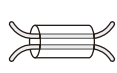

Cable  
Management



Curved Monitor

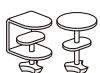

Clamp & Grommet  
Installation

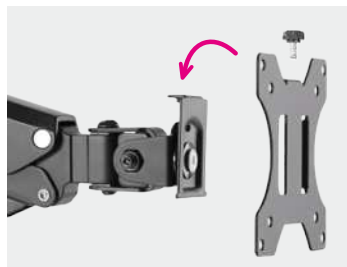

**Detachable VESA Panel**  
makes installations quick easy.



**Adjustable Gas Spring  
Tension**  
able to bear most types of  
monitor.



**Built-in Cable Management**  
create a clean look by  
eliminating cable clutter.



**Clamp & Grommet Installation**  
accommodate more users.